

PL

DIST

60°

VECT

1.33

C.S. 3A T7N R1W

30 MAY 1981

K.W.M. J.C. M.H. D

MON.

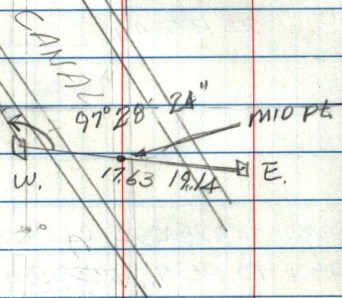

$97^{\circ} 28' 24''$

$194^{\circ} 58' 06''$

N 111° 15'

71° 22' 43"

E

122.30
34.31

122.22

115.09

D

112.12 13

112.13

$19^{\circ} 40'$

-15.52

C

680.34
29

680.29

$14^{\circ} 30'$

108.56

653.39

B

156.97.15
77.74

156.75

$15^{\circ} 07'$

153.73

A

153.40 34
36 32

153.40

$11^{\circ} 16'$

152.34

b

37.33

$6^{\circ} 45'$